

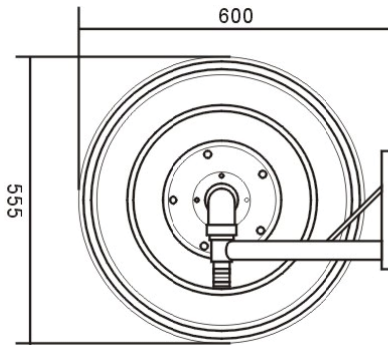

FIRE HOSE REEL EN671 APPROVED



Fireguard provide a wide choice of fire hose reels designed to provide a fast, efficient and steady flow of water to deal with a fire. Fire hose reel has been a mainstay of fire fighting for decades. The hose reels are supplied with either a manual or an automatic valve depending on the type of environment it is located.

Manually operated fire hose is recommended for exposed or exterior areas that are subject to frost or freezing conditions that could cause potential damage to the hose pipe. Water is not present within the hose until a manual gate valve is first opened before running out the hose.

By contrast, an automatic fire hose reel is permanently charged with water so that when the reel is “run out” the automatic valve will open and a quick twist of the hose reel nozzle will discharge water on to the seat of a fire. This process saves valuable time and has the potential to stop a small fire becoming a major fire. Hose Reels are available in fixed, swinging, recessed and concealed versions with automatic or manual valves. Annual servicing ensures hose reel work first time, every time and prevents potentially damaging leaks

Control Setting	Nozzle Dia	Min Flow rate at 6 Bar (L/Min)	Throw range at 2 bar (Mtr)
Jet (Hose 19/25mm)	6 mm	48/55	>10 / >12
Spray (Hose 19/25mm)	6 mm	52/62	>6

Technical Specification:

Automatic or Manual

- Hose Reel Designed to BS EN 671-part 1-2001
- Discs are 1.2mm Pre treated Electro Galvanized steel sheet with Electrostatic powder coating.
- Maximum Swinging angle wall mounted is 180°
- Hose designed to BS EN 694 non kinking reinforced rubber.
- Hose Working Pressure 12 & 20 Bar
- Hose Burst Pressure 42 & 60 Bar
- Hose Test Pressure 18 Bar
- Jet spray nozzle of rigid plastic with more than 45° spray angle – Shut- Spray- Jet pattern N-04.
- 1” Gate valve-B or Ball valve-C made of brass. Lock Shield valve is optional
- Can take 20/25/30m of 19mm or 25mm hose
- Easy to install, operate and service

Model FGHR 1930M
Manual swinging type ¾”x30m

Model FGHR 1930A
Auto swinging type ¾”x30m

Model FGHR 2530M
Manual swinging type 1”x 30m

Model FGHR 2530A
Auto swinging type 1”x30m



KM 705505



Application: Ideal for large high risk environments such as

- Schools
- Hotels
- Car parks
- Warehouses & Workshops
- Factories
- Theatres and Concert Halls
- Large petrochemical areas (using foam attachment)#



FIRE HOSE EN694



Outer layer is coated by UV inhibitor, colorfast

3/4" × 1W	WP. 12Bar	BP. 42Bar
3/4" × 2W	WP. 20Bar	BP. 60Bar
1" × 1W	WP. 12Bar	BP. 42Bar
1" × 2W	WP. 20Bar	BP. 60Bar
1 1/4"	WP. 12Bar	BP. 36Bar
1 1/2"	WP. 12Bar	BP. 36Bar

VALVE



Lock shield Valve

NORMAL NOZZLE

Nozzle Orifice Size: 7mm



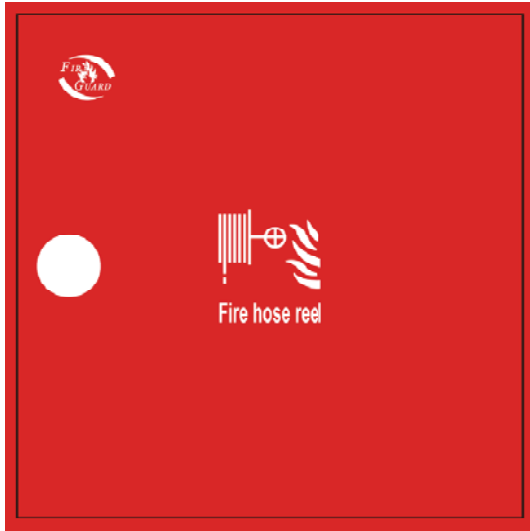

Fireguard has wide range of cabinets manufactured with 1.2mm thickness steel Powder coated RAL 3001Red.Can be customized according to the architectural requirements.

Door sign according to 92/58/EEC
35mm Ø Knockouts for inlet pipework both sides.

Finish: Red powder coated,Stainless steel-Brush/Mirror/Satin finish any other upon request.

Standard Size :Single cabinet- 760x760x280 mm Double Cabinet: 1400x760x250 mm



Optional Models with different brackets Available

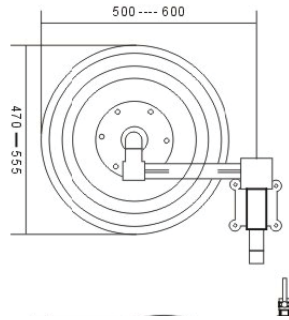

Model FGHR 1930MP -3/4" x30m Manual swinging pipe Hose reel
Model FGHR 2530MP - 1" x30m Manual swinging pipe Hose reel
Model FGHR 2530AP -1" x30m Automatic swinging pipe Hose reel

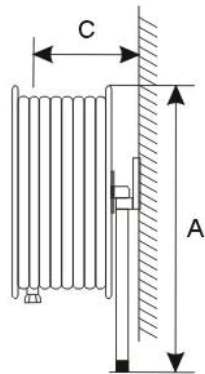
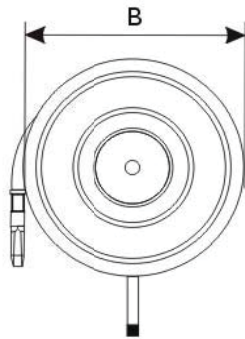

Model FGHR 1930MS -3/4" x30m Manual Fixed pipe Hose reel
Model FGHR 2530MS - 1" x30m Manual Fixed pipe Hose reel



Optional: Stainless steel drum